

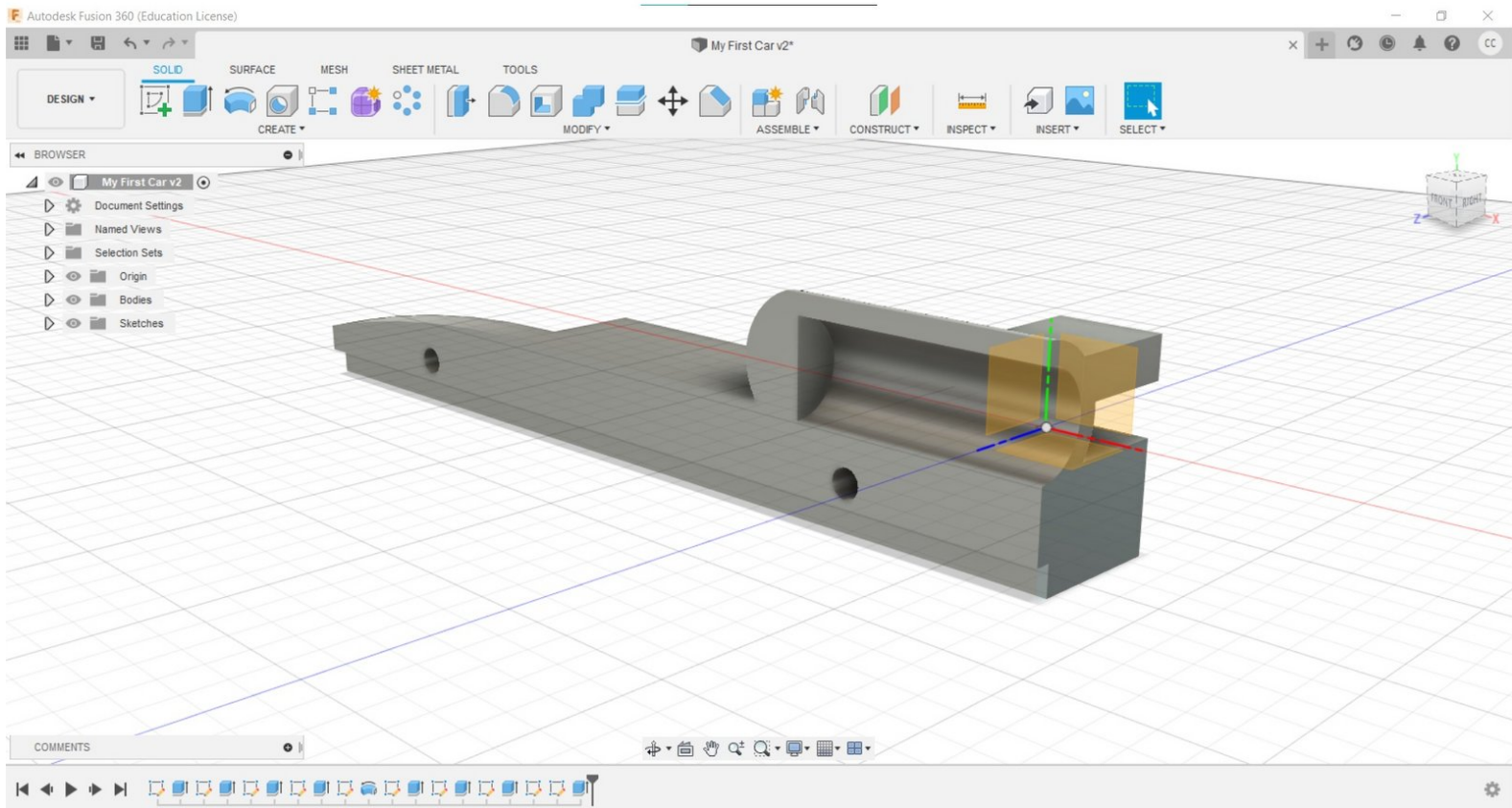

# 7 - Tether Line Slot

Written By: REA



## Step 1 — 7 - Tether Line Slot

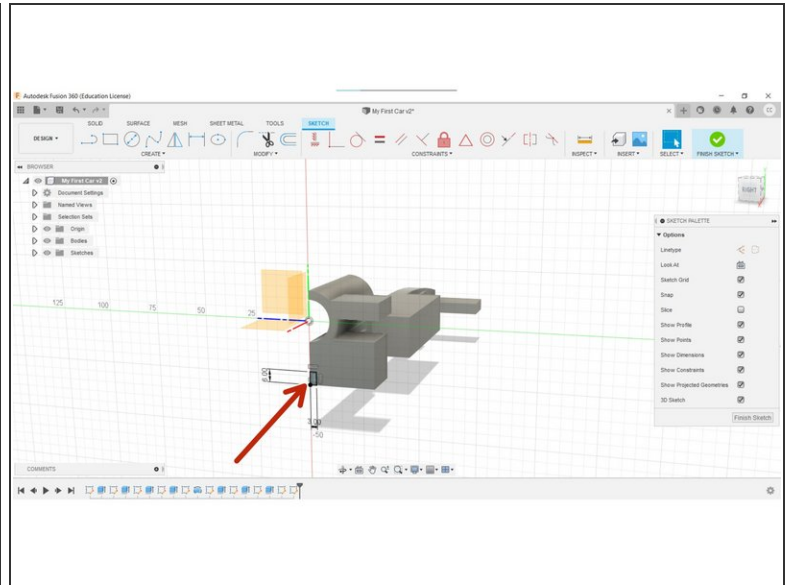
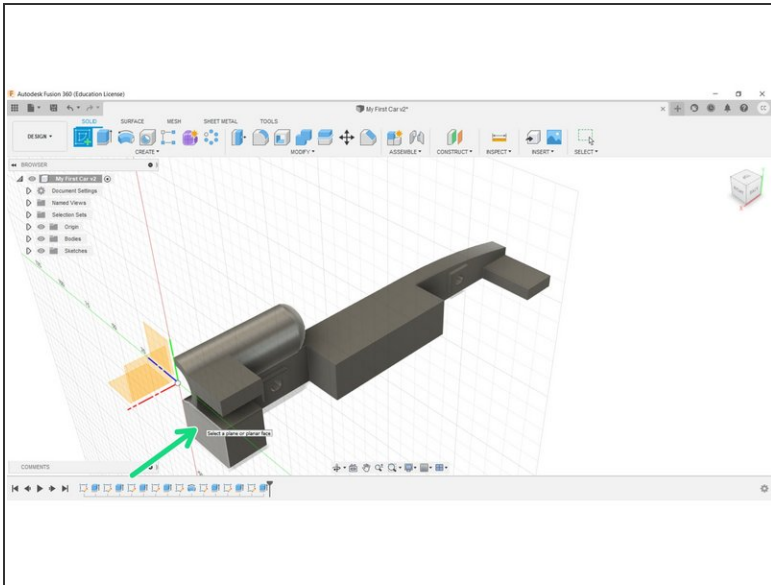

- Create a New Sketch on the rear face of the car.
- Place a 3mm (width) x 6mm (high) rectangle on the rear face, starting from the bottom left corner.

## Step 2

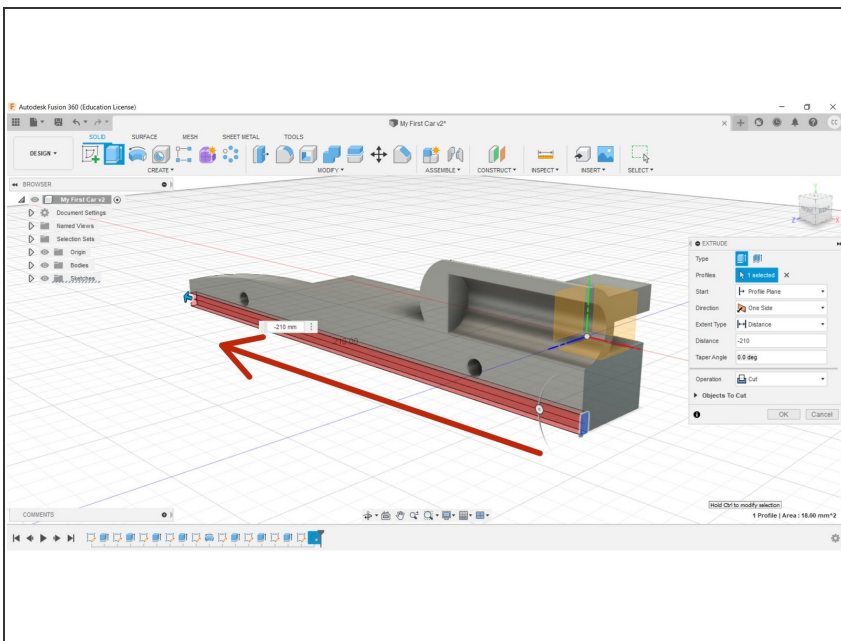

- Extrude cut the rectangle to a distance of -210mm (All of the way through the car).

## Step 3 — Finished

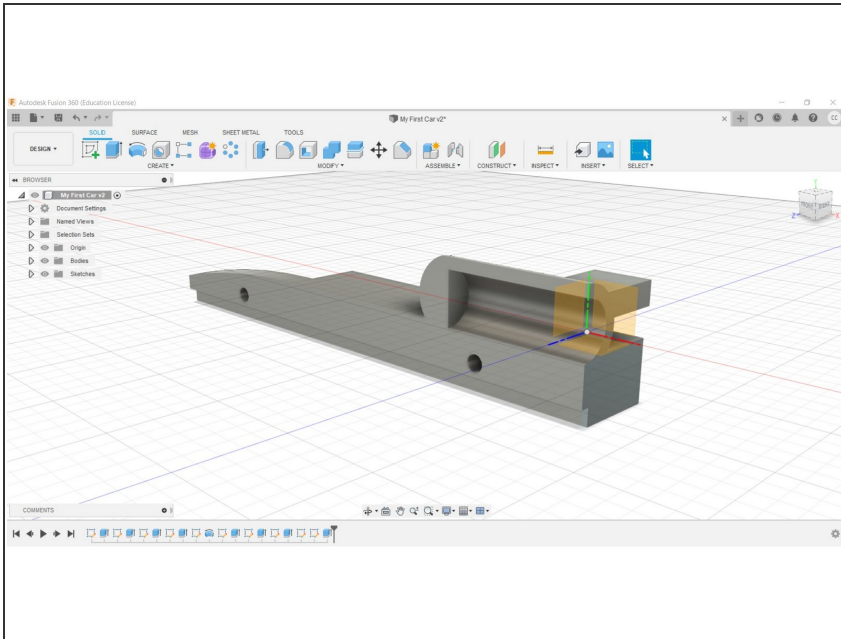

- Congratulations, you have completed this section.